

# KLSWMA35 LED WALLPACK

## INSTALLATION INSTRUCTIONS

### CAUTIONS

#### READ AND FOLLOW ALL SAFETY INSTRUCTIONS

1. DANGER- Risk of shock- Disconnect power before installation.
2. This luminaire must be installed in accordance with the NEC or your local electrical code.
3. Suitable for wet location and operation in ambient not exceeding 50°C
4. Min 75°C supply conductors.
5. Products are not intended for use in environments containing airborne corrosive agents such as chemical solvents, cleaners, or cutting fluids.
6. This luminaire is rated for 120-277Vac 60Hz only.
7. Replace the Lens if damaged

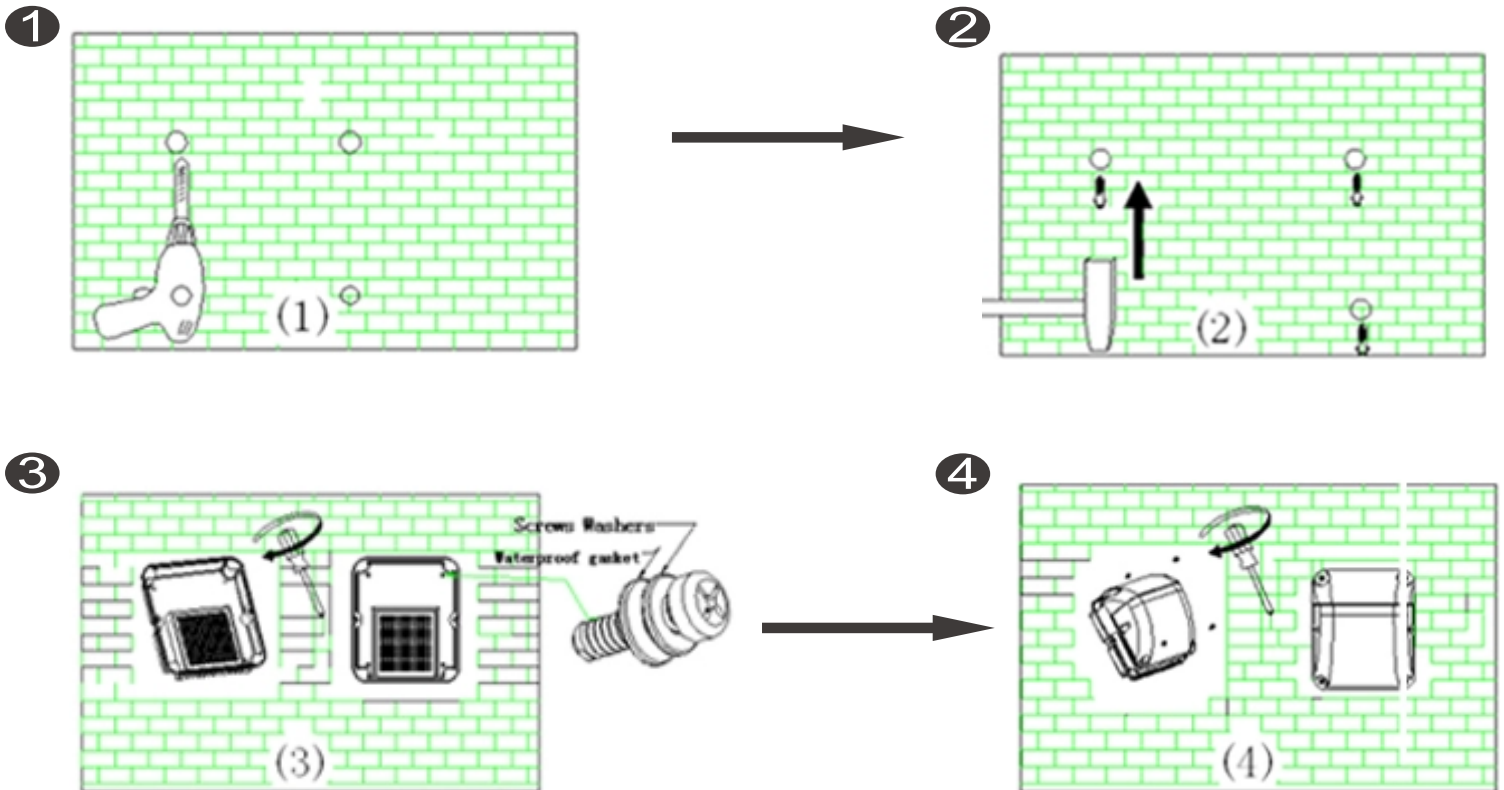

1. Drill holes where appropriate
  2. Install the expansion screw
  3. Remove the mounting plate from the back of the fixture by loosening the mounting plate.
  4. Install the mounting plate and hang the fixture to the mounting plate.
- Complete the wiring to the power source and ground, make the following electrical connections in the mounting box or junction box:
- a. Connect the black lead to the voltage supply lead
  - b. Connect the white lead to the neutral supply lead
  - c. Connect the ground lead to the supply ground lead.